

---

Ref. no.: 220

---

# Shut-off damper

*With lip sealing system*



**Airtight according to DIN EN 1751 class 4**

**Push-fit ends airtight according to DIN EN 12237 class D**

**Spigot ends calibrated according to DIN 24147 part 1**

**Laser-welded housing**

 Especially suitable for **visible installation**. The components can easily be separated from each other again.



**AEROTECHNIK  
SIEGWART**

Aerotechnik E. Siegwart GmbH  
Untere Hofwiesen • D-66299 Friedrichsthal  
☎ +49 (0) 6897/859-0 • 📠 +49 (0) 6897/859-150  
[www.aerotechnik.de](http://www.aerotechnik.de) • [info@aerotechnik.de](mailto:info@aerotechnik.de)

Ref. no.: 220

# Shut-off damper manual - electronic - pneumatic

## Shut-off damper - airtight according to DIN EN 1751 class 4

Advantages and construction details:

**Housing:** The housing is made from galvanized or stainless steel. It is laser-welded without any intruding fold. The smooth surface of the housing enables the inclusion of **lip sealing**. The male couplings are press-calibrated according to DIN 24147 part 1 and consequently they are dimensionally stable and fit accurately.

**In flow direction, the seal of the shut-off damper is airtight up to a pressure of 1000 Pa according to DIN EN 1751 class 4 (certificated by the Technical Inspection Authority).**

**Adjustment:** The standard shut-off dampers are equipped with manual adjustment device which locks automatically (there are no tools necessary for adjustment and regulation). They can be used for electric remote regulation, too.

**Insulation:** On request, the shut-off damper including cover set is available with insulation in depths of 25 or 50 mm.

**Installation:** According to DIN 1946 part 4, there must exist an accessibility to the duct system and the damper in order to actuate and maintain the latter.

**Range of temperature:** Shut-off dampers operate within a temperature range from -15 °C to +100 °C.

### Sealing system of the

**male coupling:** The push-fit ends with lip sealing are airtight according to DIN EN 12237 class D.

**Robustness:** In general the lip sealing is insensitive to damages in case of slightly canted or badly trimmed ducts.

**Exchange:** If the lip sealing should be damaged or lost, it is only necessary to put on a new loose sealing ring.

**Dismounting:** Because of the conception of the sealing, the components can easily be separated from each other again.

### Visible

**installation:** Because no additional sealing components (tape e.g.) are required, the sealing conception with lip sealing system is especially suitable for visible installation. Attractive, architectural design which is up-to-date.

**Hygiene:** The smooth surface of the laser-welded housing prevents the accumulating of dirt and dust particles.

**Stability:** Non-ageing lip sealing made of EPDM - a material which is resistant to slightly aggressive vapours and chemical products.



Aerotechnik E. Siegwart GmbH  
Untere Hofwiesen • D-66299 Friedrichsthal  
☎ + 49 (0) 6897/859-0 • 📠 +49 (0) 6897/859-150  
www.aerotechnik.de • info@aerotechnik.de

Ref. no.: 220

# Shut-off damper manual adjustment device (AKH)

## Version 1:

### Size 80 - 250:

- shut-off damper with tight male coupling (only fitting dimension)
- adjustment and intermediate lock due to ratchet disc and lever
- shut-off damper can be converted into motor adjustment at any time,  
**no complex installation required** (see version 2)

- $l_1$  = fitting dimension
- $l_3$  = overall length =  $l_1 + (2 \times l_2)$

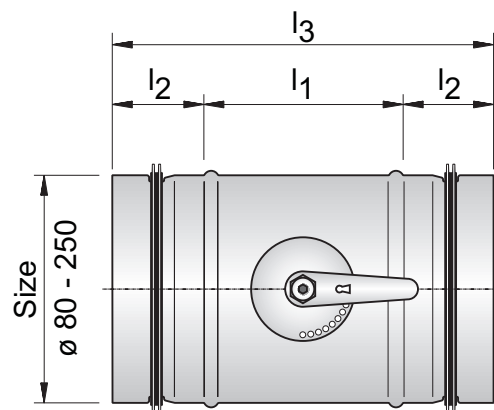

### Size 280 - 450:

- adjustment and intermediate lock due to ratchet disc and lever
- shut-off damper can be converted into motor adjustment at any time,
- **no complex installation required** (see version 2)

- $l_1$  = fitting dimension
- $l_3$  = overall length =  $l_1 + (2 \times l_2)$

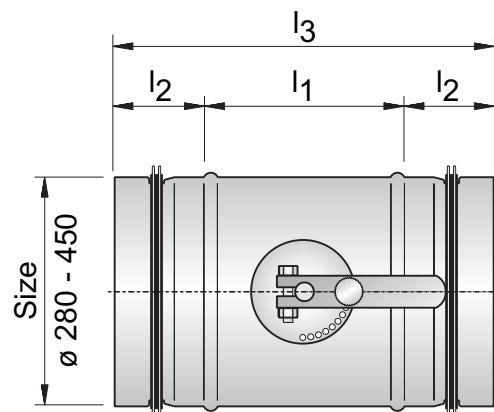

### Size 500 - 630:

- reinforced continuous axle
- adjustment without steps due to lever

- $l_1$  = fitting dimension
- $l_3$  = overall length =  $l_1 + (2 \times l_2)$

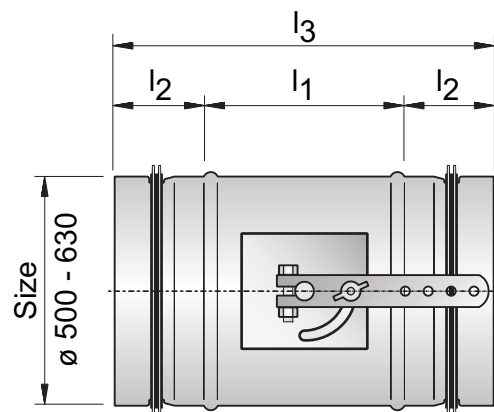

**AEROTECHNIK  
SIEGWART**

Aerotechnik E. Siegwart GmbH  
Untere Hofwiesen • D-66299 Friedrichsthal  
☎ +49 (0) 6897/859-0 • 📠 +49 (0) 6897/859-150  
[www.aerotechnik.de](http://www.aerotechnik.de) • [info@aerotechnik.de](mailto:info@aerotechnik.de)

Ref. no.: 220

# Shut-off damper for motor adjustment (AKM)

## Version 2:

### Size 80 - 250:

- shut-off damper with tight male coupling (only fitting dimension)
- bracket for electronic actuator can also be used for other makes
- depending on the mounting situation or indication made by the customer, the bracket can be arranged **lengthwise** as well as **crosswise** to the housing (actuator is not included in the scope of delivery)
- $l_1$  = fitting dimension
- $l_3$  = overall length =  $l_1 + (2 \times l_2)$

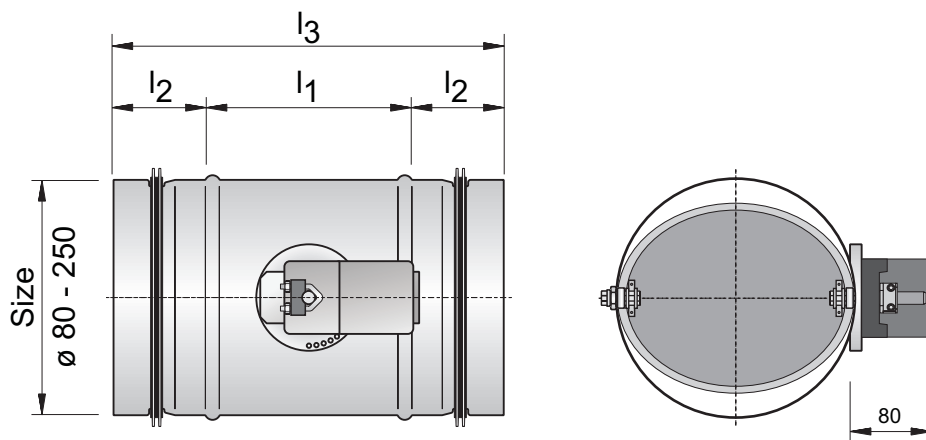

### Size 280 - 630:

- reinforced axle execution
- $l_1$  = fitting dimension
- $l_3$  = overall length =  $l_1 + (2 \times l_2)$

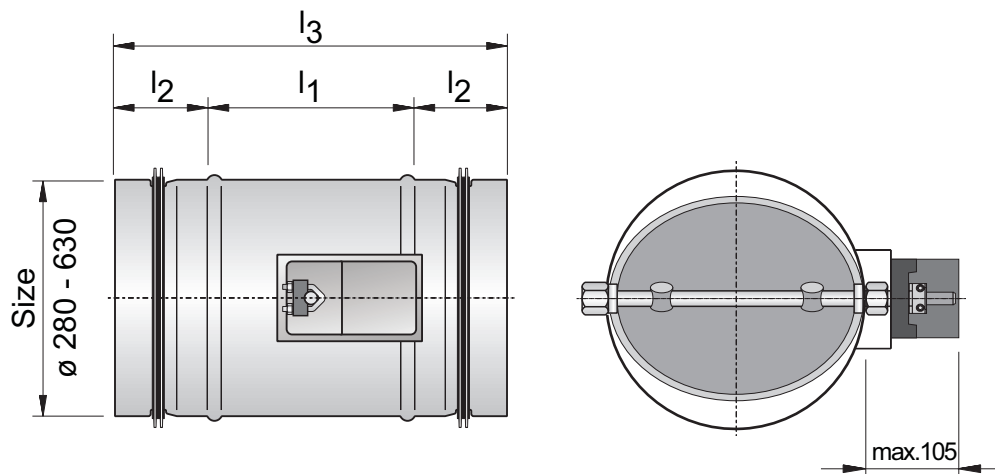

Aerotechnik E. Siegwart GmbH  
Untere Hofwiesen • D-66299 Friedrichsthal  
☎ + 49 (0) 6897/859-0 • 📠 +49 (0) 6897/859-150  
www.aerotechnik.de • info@aerotechnik.de

Ref. no.: 220

# Shut-off damper for pneumatic adjustment (AKP)

## Version 3:

### Size 80 - 630:

- shut-off damper with tight male coupling (only fitting dimension)
- reinforced axle execution from size 280 mm on
- bracket for pneumatic actuator - can also be used for other makes
- depending on the mounting situation or indication made by the customer, the bracket can be arranged **lengthwise** as well as **crosswise** to the housing (actuator is not included in the scope of delivery)

- $l_1$  = fitting dimension
- $l_3$  = overall length =  $l_1 + (2 \times l_2)$

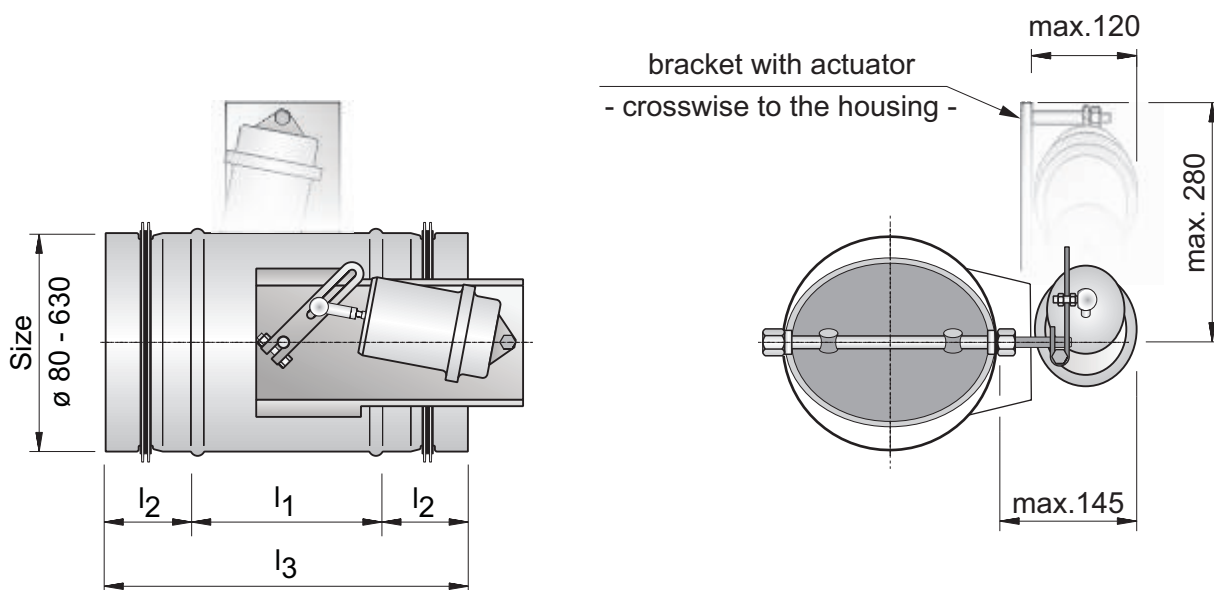

**ATEX design against extra charge**

**Design with flat flange or  
board with tension ring  
on request**

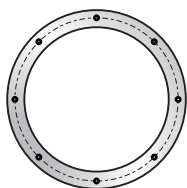

**AEROTECHNIK  
SIEGWART**

Aerotechnik E. Siegwart GmbH  
Untere Hofwiesen • D-66299 Friedrichsthal  
☎ + 49 (0) 6897/859-0 • 📠 +49 (0) 6897/859-150  
[www.aerotechnik.de](http://www.aerotechnik.de) • [info@aerotechnik.de](mailto:info@aerotechnik.de)

Ref. no.: 220

# Shut-off damper

## Manual - electronic - pneumatic

Thickness of insulation: 25 mm or 50 mm

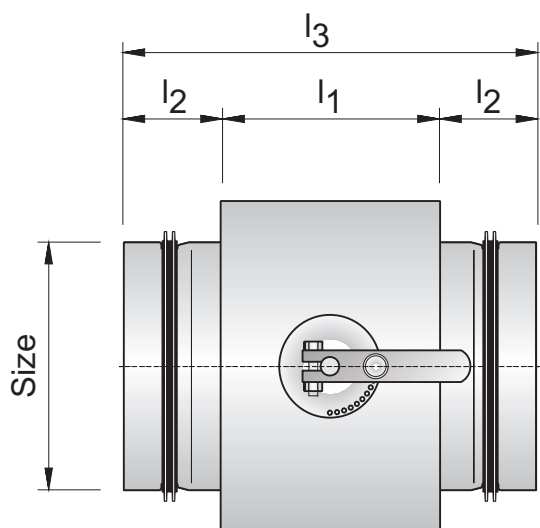

- $l_1$  = fitting dimension
- $l_3$  = overall length =  $l_1 + (2 \cdot l_2)$
- Size = diameter in mm

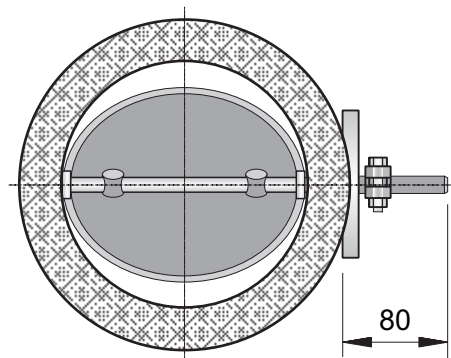

Size [mm]	Dimension			Weight
	$l_1$ [mm]	$l_2$ [mm]	$l_3$ [mm]	
80	115	40	195	0,7
100	115	40	195	0,7
125	115	40	195	0,8
140	115	40	195	0,9
150	115	40	195	0,9
160	115	40	195	1,0
180	115	40	195	1,1
200	135	40	215	1,3
224	135	40	215	1,5
250	135	40	215	1,7
280	125	60	245	3,6
300	125	60	245	4,5
315	125	60	245	4,8
355	125	60	245	5,9
400	125	60	245	7,4
450	125	60	245	9,0
500	265	60	385	12,5
560	265	60	385	14,8
600	465	60	585	19,0
630	465	60	585	20,5

Tolérance de fabrication pour les dimensions en longueur  $\pm 5$  mm



Aerotechnik E. Siegwart GmbH  
 Untere Hofwiesen • D-66299 Friedrichsthal  
 ☎ +49 (0) 6897/859-0 • 📠 +49 (0) 6897/859-150  
 www.aerotechnik.de • info@aerotechnik.de